

IMPORTANT

Before installation, please make sure that all accessories are ready.
(As shown in the picture below)

PRODUCT INFORMATION

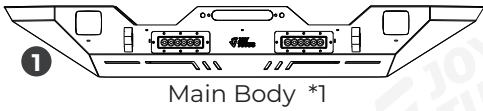

1 Main Body *1

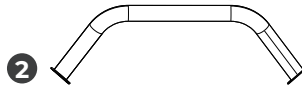

2 Protection Tube *1



3 D-ring *2



4 M10 Spring Washer *10
(Include 2 spares)



5 Ø10*25*1.5 Flat Washer *10
(Include 2 spares)



6 M10 Hex Nuts *10
(Include 2 spares)

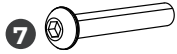

7 M6X20 Button Head Bolt *8
(Include 2 spares)



8 M6 Spring Washer *8
(Include 2 spares)



9 Ø6*16*1.0 Flat Washer *8
(Include 2 spares)



10 M6 Flange Nuts *8
(Include 2 spares)

INSTALLATION COMPLETION DIAGRAM



CUSTOMER SUPPORT

Contact us by email:
service@joytutus.com

JOYTUTUS help center:

<http://support.joytutus.com>

✓ INSTALLATION METHOD

STEP 1: Remove the original factory bumper.

- 1) Remove the 4 rivets that secure the splash guard and take off the splash guard.
- 2) Remove the 2 rivets located between the grille and the front bumper that are used to secure the frame guard.
- 3) Disconnect the fog lamp connector.
- 4) Remove the 8 M12 hex nuts that fasten the bumper to the frame side members.
- 5) Carefully remove the front bumper.

STEP 2: Assemble the new bumper.

Required accessories:

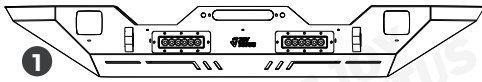

Main Body *1

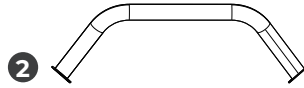

Protection Tube *1



D-ring *2

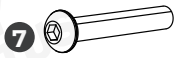

M6X20 Button Head Bolt *6



M6 Spring Washer *6



Ø6*16*1.0 Flat Washer *6



M6 Flange Nuts *6

You need to prepare the 4mm, 17mm sockets, torque wrench, and ratchet wrench by yourself.

STEP 2-1

- 1) Secure Components [1] and [2] using Parts [7], [8], [9], and [10].
- 2) Tighten the M6 hardware to 15 ft.lbs of torque.

Installation Diagram

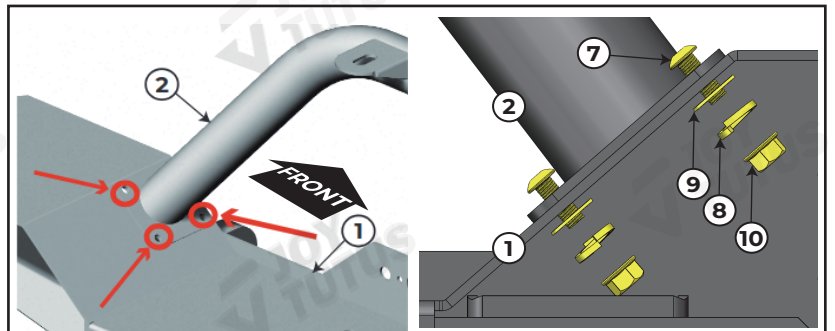
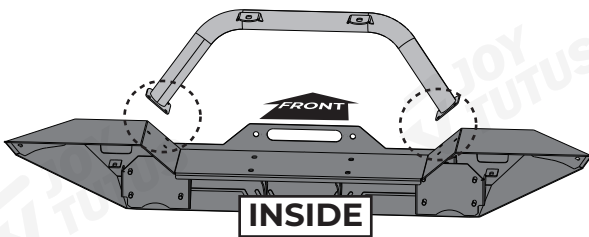

STEP 2-2

Just install the D-rings on both sides.

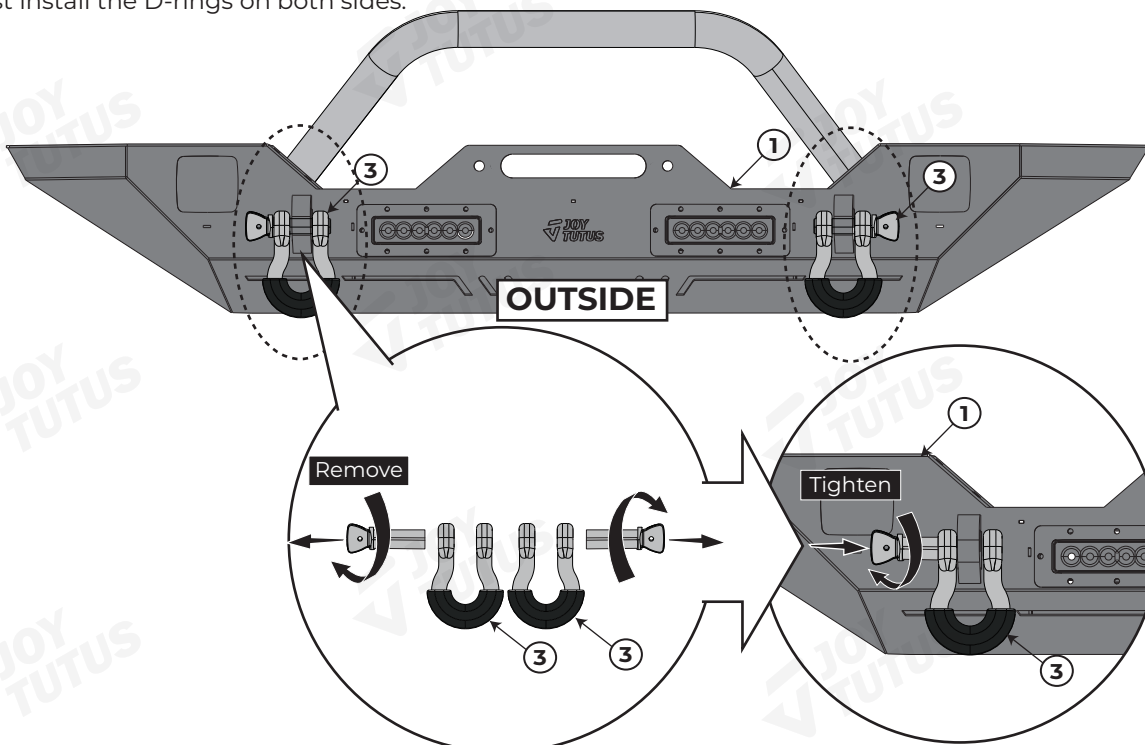

STEP 3: Install the new bumper.

Required accessories:

4  M10 Spring Washer *8

5  $\varnothing 10 \times 25 \times 1.5$ Flat Washer *8

6  M10 Hex Nuts *8

You need to prepare the 4mm, 17mm, 19mm sockets, torque wrench, and ratchet wrench by yourself.

Installation Diagram

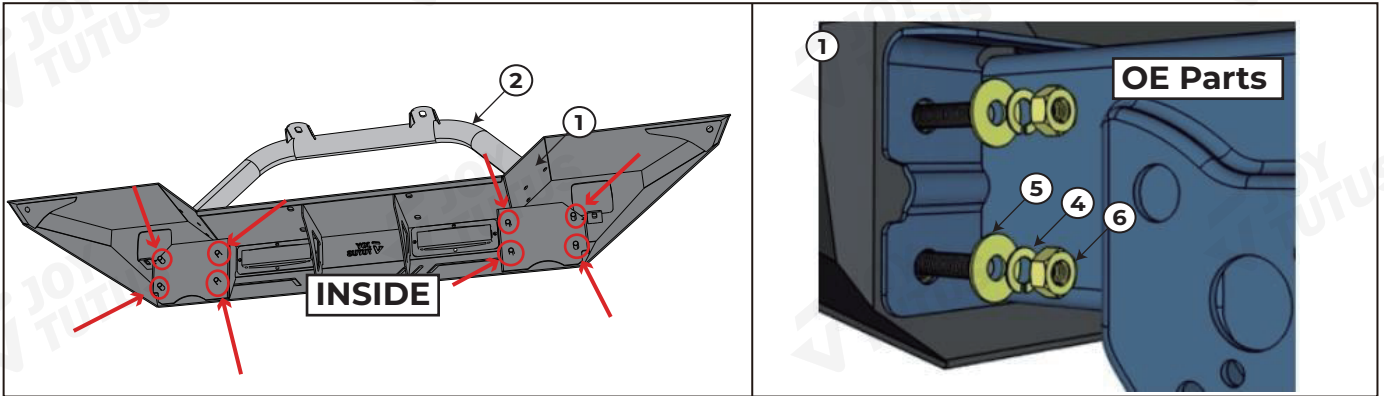

- 1) Install the bumper onto the frame rails with the help of auxiliary tools (or assistance from another person).
- 2) Secure the bumper to the frame rails using Parts [4], [5], and [6].
- 3) Tighten the M10 fasteners to a torque of 31 ft.lbs.

STEP 4: Wiring installation.

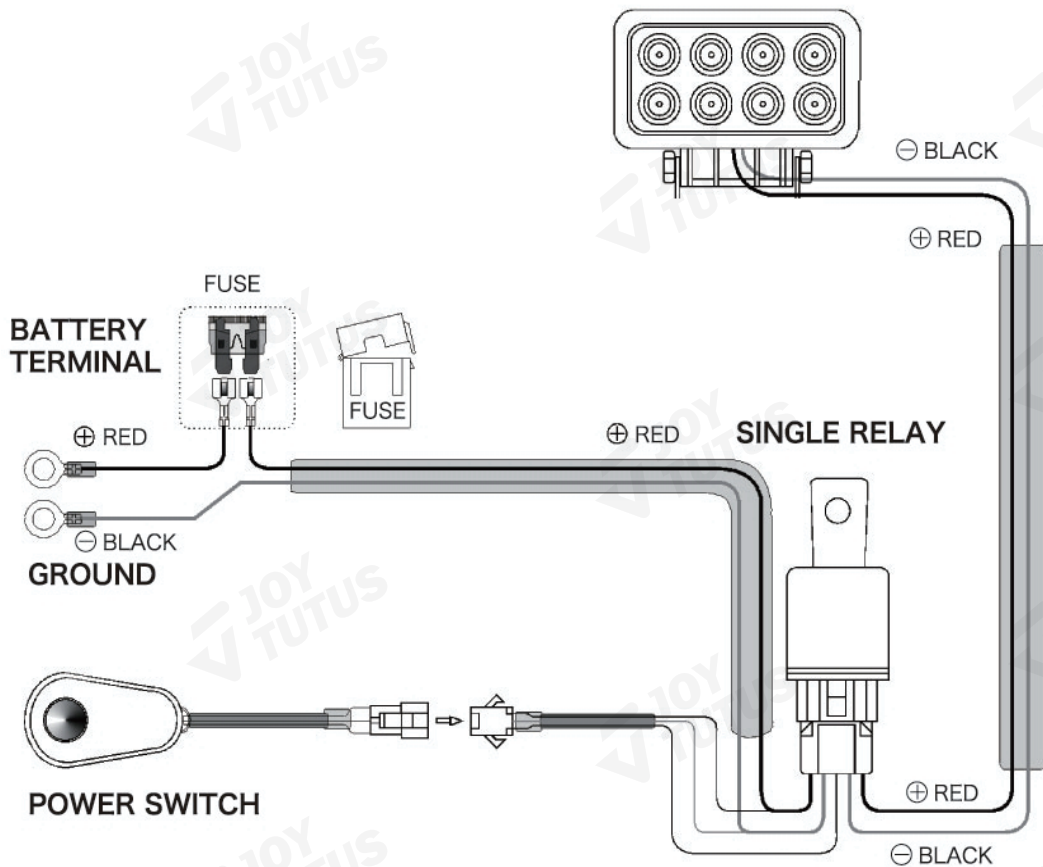

- 1) For your safety, please select a wire harness equipped with a relay and a fuse.
- 2) Please refer to the wiring diagram as shown above.
- 3) The wire harness is not included with this product.

Installation Images Disclaimer :

All installation images provided are for reference purposes only. The actual product may vary slightly from the images shown. However, the installation process remains the same.

Safety Reminder:

For your safety, please regularly inspect all accessories connected to the vehicle to ensure they are securely fastened and functioning properly.

Important Electrical Notice:

This bumper includes integrated LED lights that require proper power connection. Incorrect installation may cause permanent damage to the lights or your vehicle's electrical system, and could pose a safety risk. If you are not experienced with vehicle wiring, we strongly recommend having the connections made by a qualified professional installer.

Light Parameter Display:

Light name	Light model	Photo	Quantity	Power	Input voltage	Protection rating
Work light 1	D1		2	48W	10-30V DC	IP 67
Work light 2	D2		2	42W	10-30V DC	IP 67

WARNING

FCC STATEMENT :

This device complies with Part 15 of the FCC Rules. Operation is subject to the following two conditions:

- (1) This device may not cause harmful interference.
- (2) This device must accept any interference received, including interference that may cause undesired operation.

Warning: Changes or modifications not expressly approved by the party responsible for compliance could void the user's authority to operate the equipment.

NOTE: This equipment has been tested and found to comply with the limits for a Class B digital device, pursuant to Part 15 of the FCC Rules. These limits are designed to provide reasonable protection against harmful interference in a residential installation. This equipment generates uses and can radiate radio frequency energy and, if not installed and used in accordance with the instructions, may cause harmful interference to radio communications. However, there is no guarantee that interference will not occur in a particular installation. If this equipment does cause harmful interference to radio or television reception, which can be determined by turning the equipment off and on, the user is encouraged to try to correct the interference by one or more of the following measures:

- (1) Reorient or relocate the receiving antenna.
- (2) Increase the separation between the equipment and receiver.
- (3) Connect the equipment into an outlet on a circuit different from that to which the receiver is connected.
- (4) Consult the dealer or an experienced radio/TV technician for help.

FCC Radiation Exposure Statement:

This equipment complies with FCC radiation exposure limits set forth for an uncontrolled environment. This equipment should be installed and operated with minimum distance 20cm between the radiator & your body.

If you have any questions, please visit Joytutus website for quick response.

Web: www.joytutus.com