

IMPORTANT

For safety and to ensure a satisfactory installation, please read the installation steps below before you install this kit.

PRODUCT INFORMATION

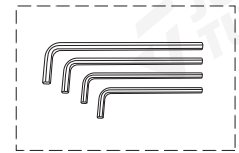
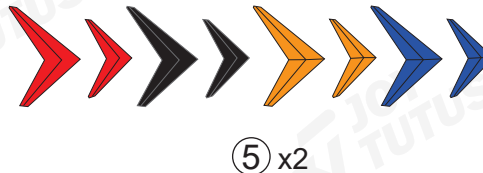
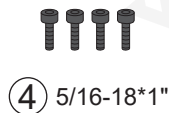
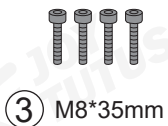
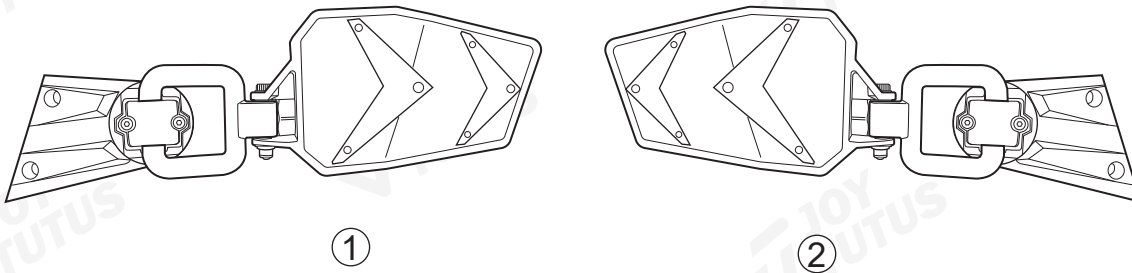

INSTALLATION METHOD

Wrangler JK JKU

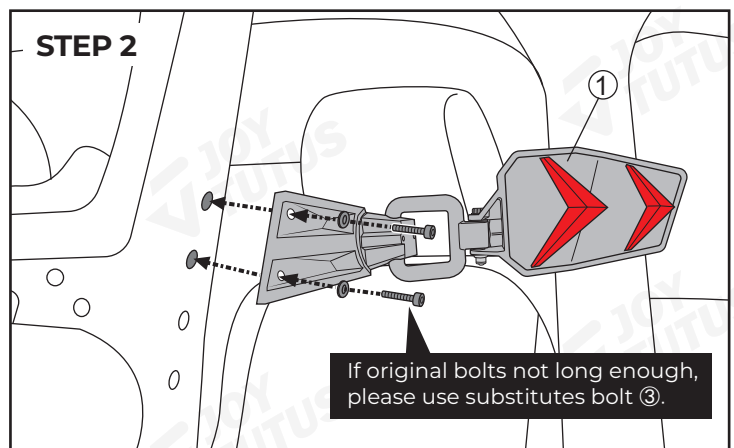
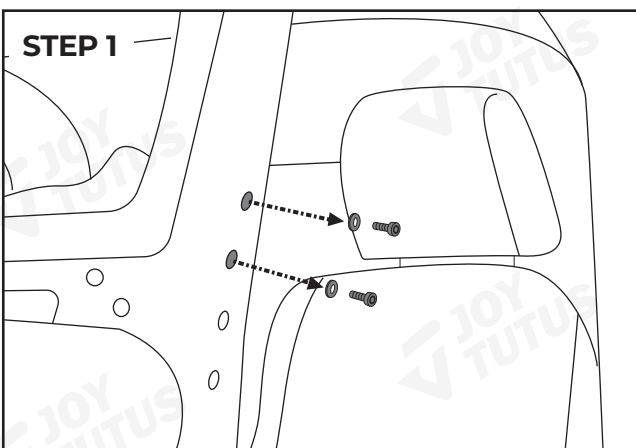

STEP 1 : Remove two original flush mount torx head bolts and washers just in front of door hinge.

STEP 2 : Use the two original bolts and washers just removed to fix the bracket on the flat side.

STEP 3 : Repeat steps 1-2 to install the other side.

Wrangler TJ

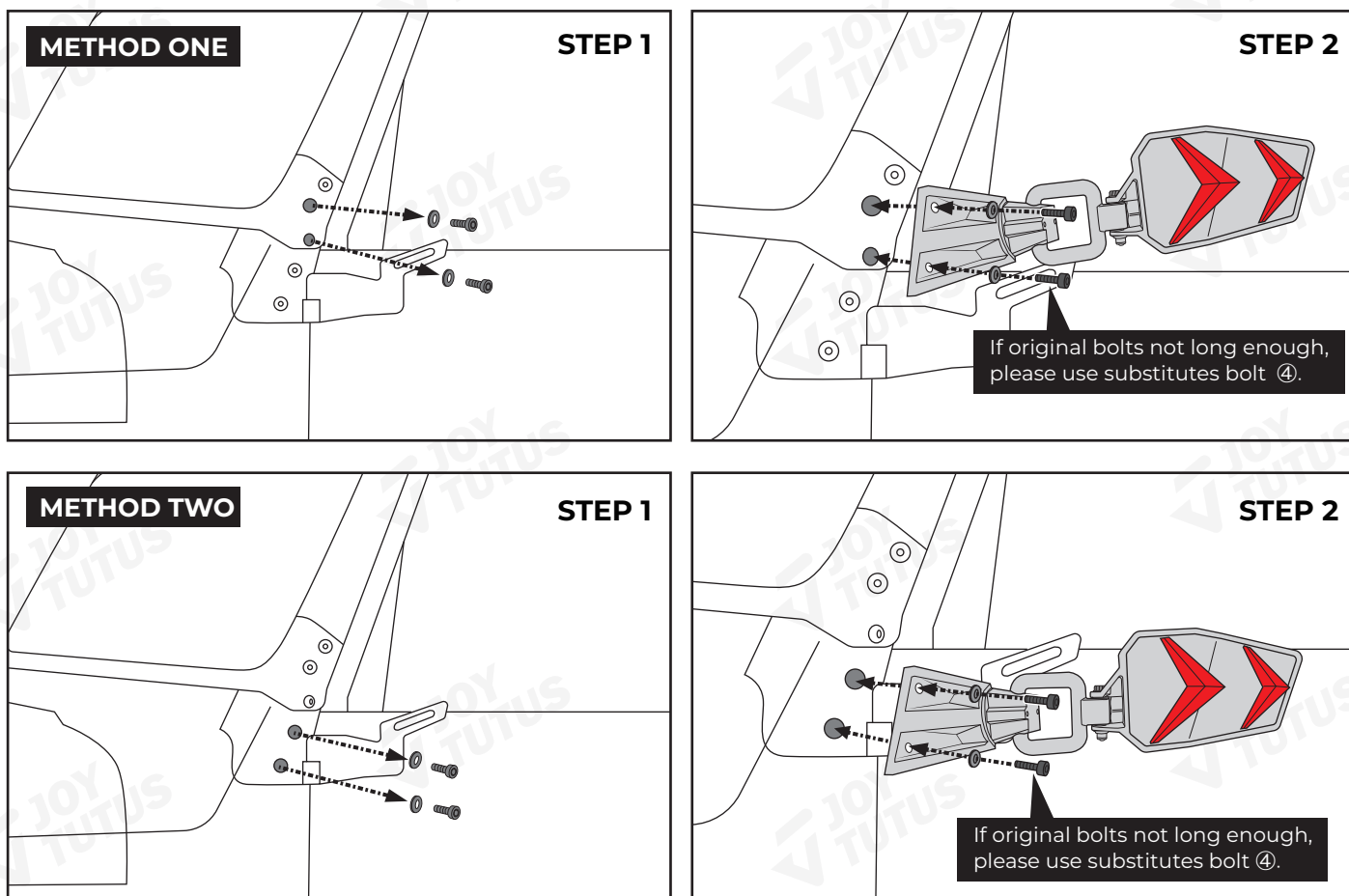

STEP 1 : Remove two original flush mount torx head bolts and washers just in front of door hinge.

STEP 2 : Use the two original bolts and washers just removed to fix the bracket on the flat side.

STEP 3 : Repeat steps 1-2 to install the other side.

✓ FUNCTION DESCRIPTION

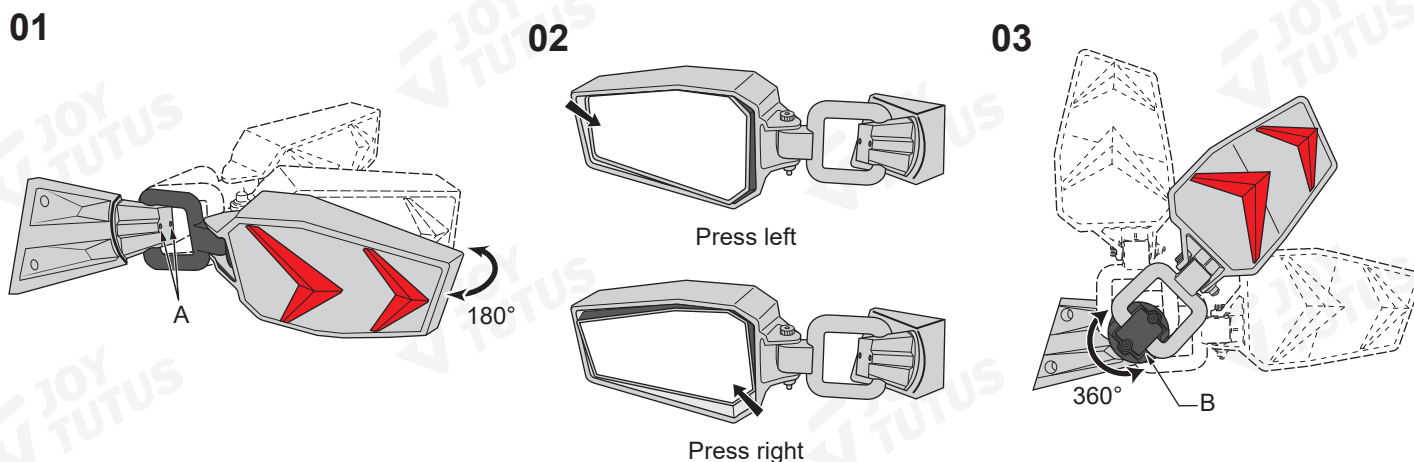

01) Adjust the screw A, you can swing frame front and back by 180°.

02) Press the mirror to adjust the angle.

03) You can swing bracket B front and back by 360°.

If you have any questions, please visit Joytutus website or email for quick response.

Web: www.joytutus.com

Email: Service@joytutus.com