

IMPORTANT

Before installation, please make sure that all accessories are ready. (As shown in the picture below).

PRODUCT INFORMATION

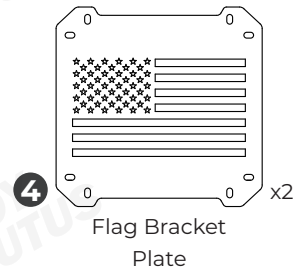
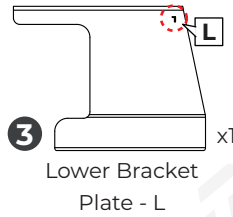
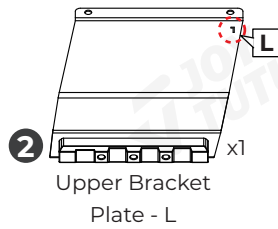
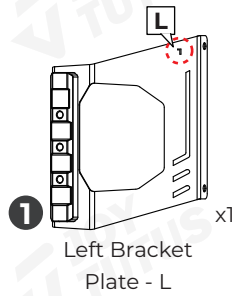

5 x12
M4*L8 Screw with Washer

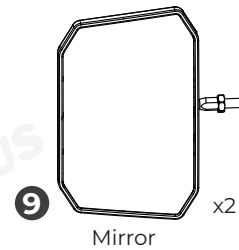
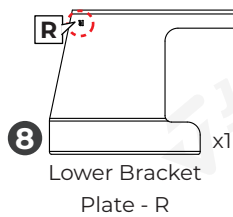
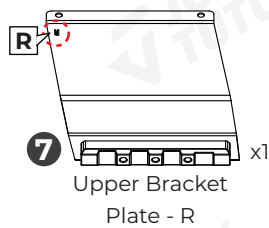
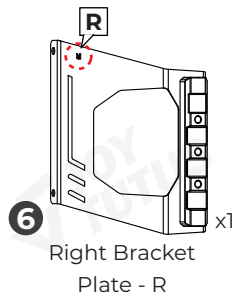

10 x2
Adapter M6-1/4-20

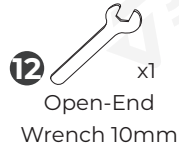

INSTALLATION COMPLETION DIAGRAM

Driver side

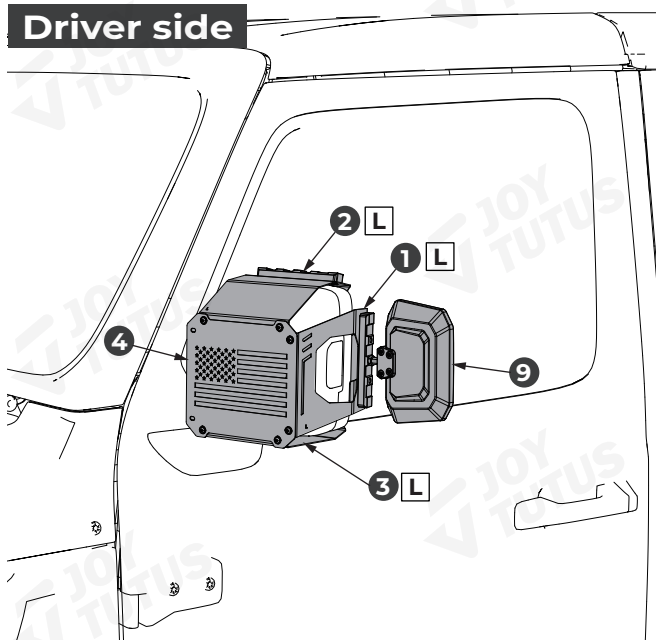

Passenger side

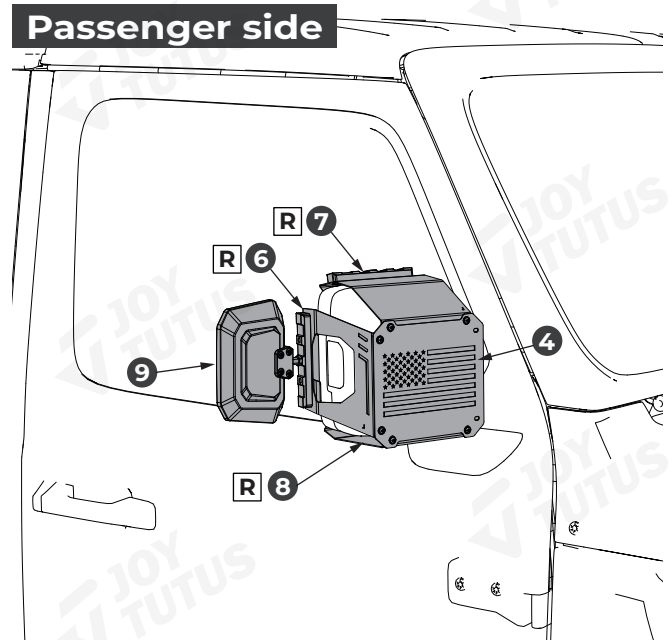

✓ INSTALLATION TIPS

Required accessories:

(The same procedure applies to the other side.
Then, the installation is complete.)

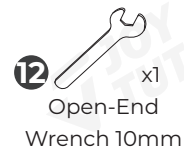
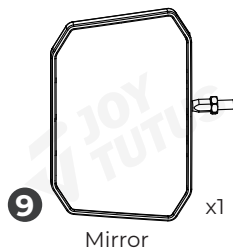
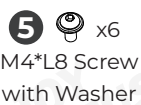
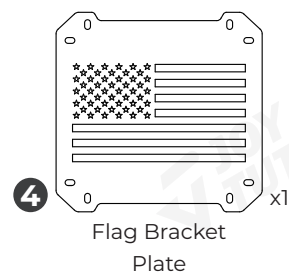
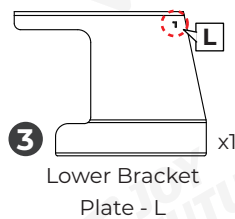
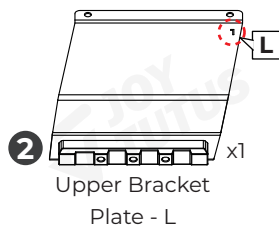
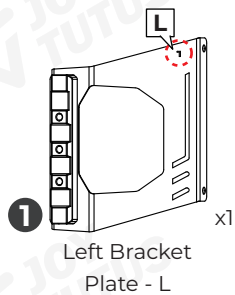

STEP 1

Assemble [2] and [4] with two screws [5], but do not fully tighten the screws [5].

Installation hole schematic:

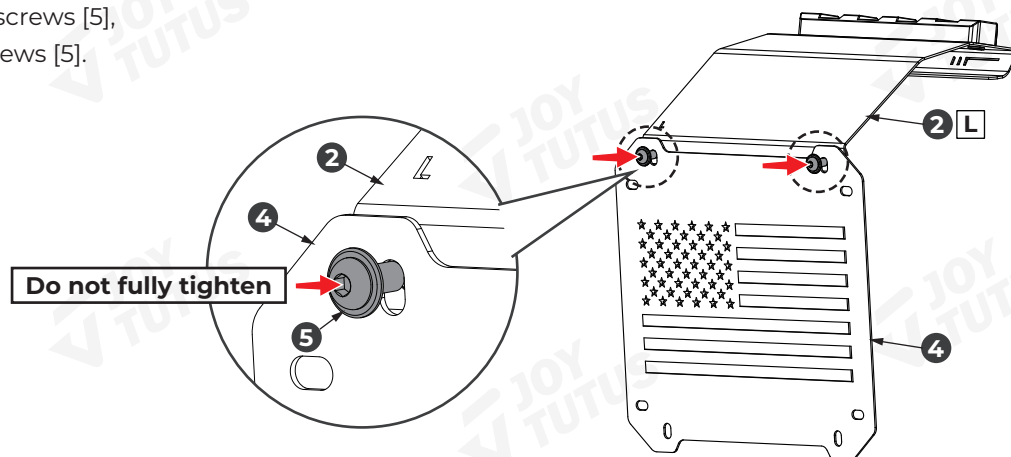
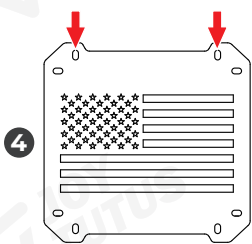

STEP 2

Assemble [3] and [4] with two screws [5], but do not fully tighten the screws [5].

Installation hole schematic:

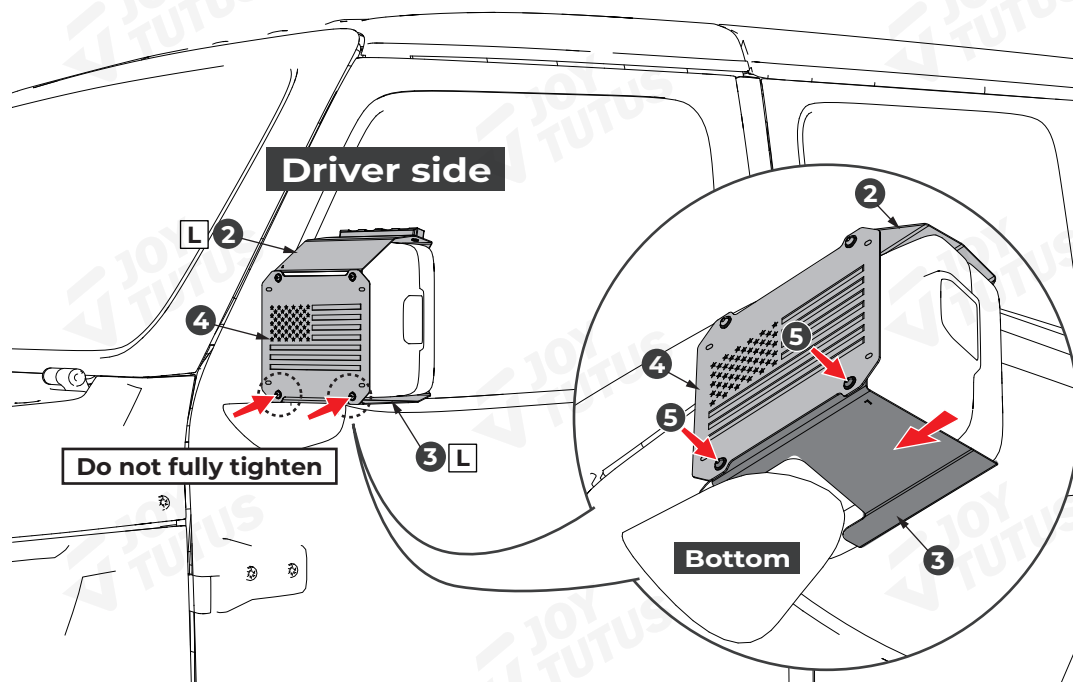
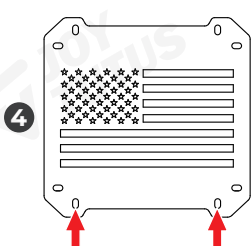

STEP 3

Assemble [1] and [4] with two screws [5]. At the same time, press the metal plates with your hand while tightening all the screws [5].

Installation hole schematic:

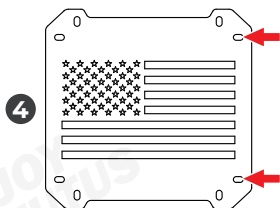

Prerequisite:

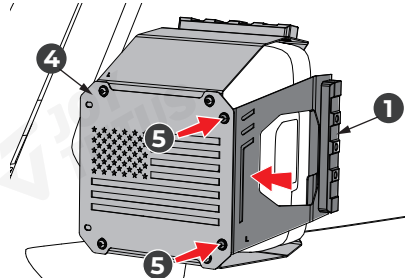

Do not fully tighten

Driver side

Press tightly to tightening all the screws [5]

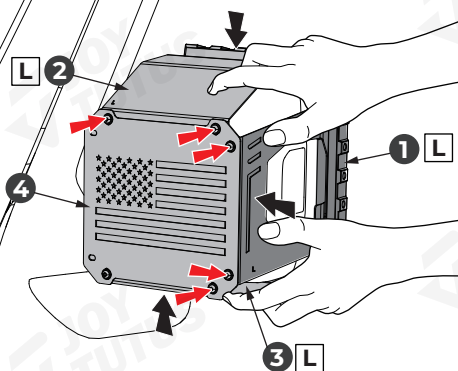

STEP 4

Install the mirror [9] in the appropriate position, then tighten the nut with an open-end wrench [12] to complete the installation.

Driver side

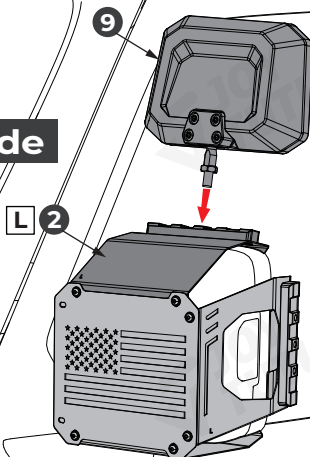

OR

Driver side

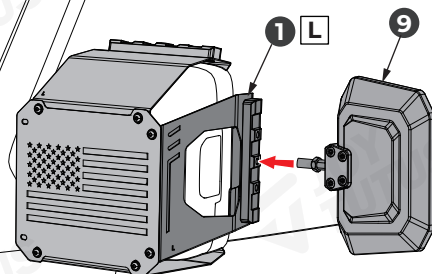

Repeat Steps 1-4 to install the other side.

√ FUNCTION

01) It can rotate 360° for adjustment.

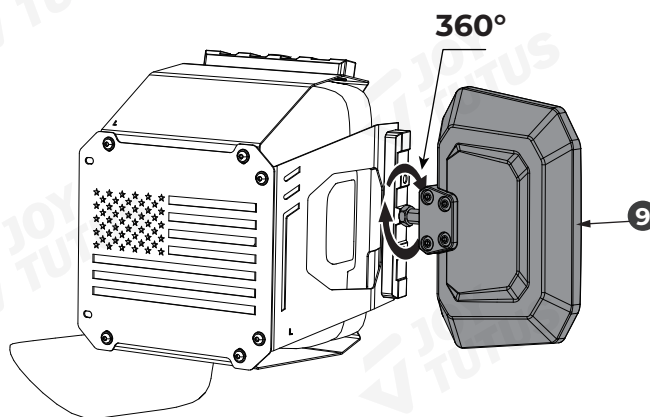

02) It can be installed with a GoPro or other products.

Required accessories:

10  x1
Adapter
M6-1/4-20



03) The mirror [9] can be installed on the side or on the top, with three positions reserved for installation in both cases.
(It is recommended to install it in the middle threaded hole.)

