

IMPORTANT

Before installation, please make sure that all accessories are ready. (As shown in the picture below).

PRODUCT INFORMATION

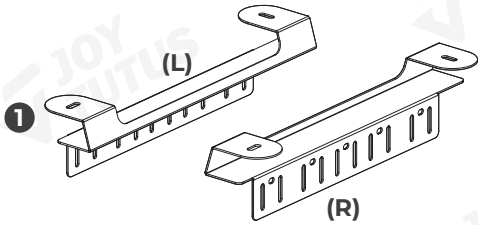

Base (left and right) x1

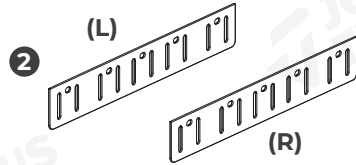

Base EVA Single-Sided Adhesive (left and right) x1

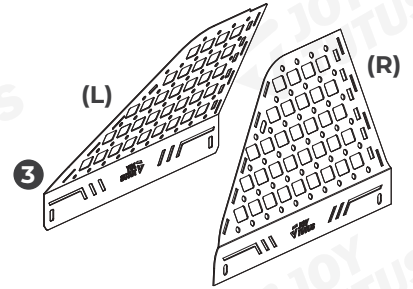

Side Plate x1

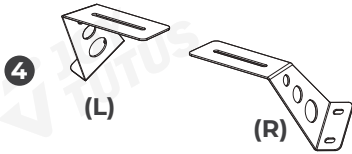

Roof Rack Support Plate 1 (left and right) x1

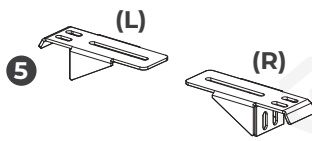

Roof Rack Support Plate 2 (left and right) x1

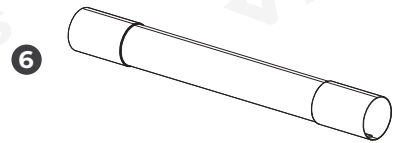

Cross Tube

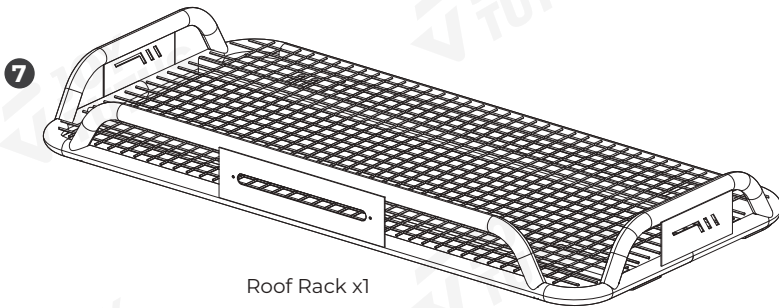

Roof Rack x1

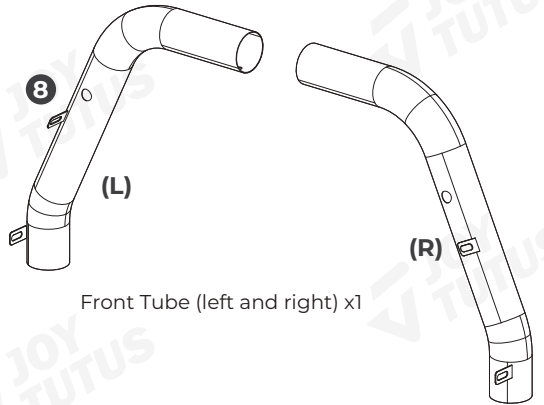

Front Tube (left and right) x1

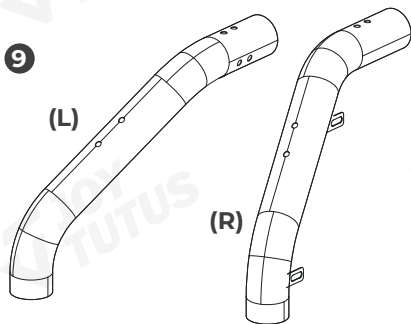

Rear Tube (left and right) x1



Rear Tube Connector Rubber Part x2



Lower Bend Plate x4



Sliding Channel Nut Plate x4



Rubber plug x2



Front Tube/Rear Tube Rubber Ring x4

(Install Base)

15 M10x35 Flat Head Socket Cap Screw x4

16 Ø10*25*1.5 Flat Washer x4

17 Ø10 Spring Washer x4

(For mounting on vehicle)

18 M8*35 Hex Head Bolt x8

19 Ø8*20*2.0 Flat Washer x8

20 Ø8 Spring Washer x8

(Connect front and rear tubes)

21 M10*35 Button Head Socket Cap Screw x2

22 Ø10*20*1.5 Flat Washer x2

23 Ø10 Spring Washer x2

(Install cross tube and roof rack and side plate)

24 M8*25 Flat Round Head Socket Cap Screw x32

25 Ø8*20*1.5 Flat Washer x48

26 Ø8 Spring Washer x32

27 M8 Flange Nut x16

(Installation tool: Hex Key)

28 S=5

29 S=6

30 S=8

31 Spare Parts Kit

Customer Support



Contact us by email: service@joytutus.com

JOYTUTUS help center:
<http://support.joytutus.com>



✓ INSTALLATION COMPLETION DIAGRAM

Installation Instructions

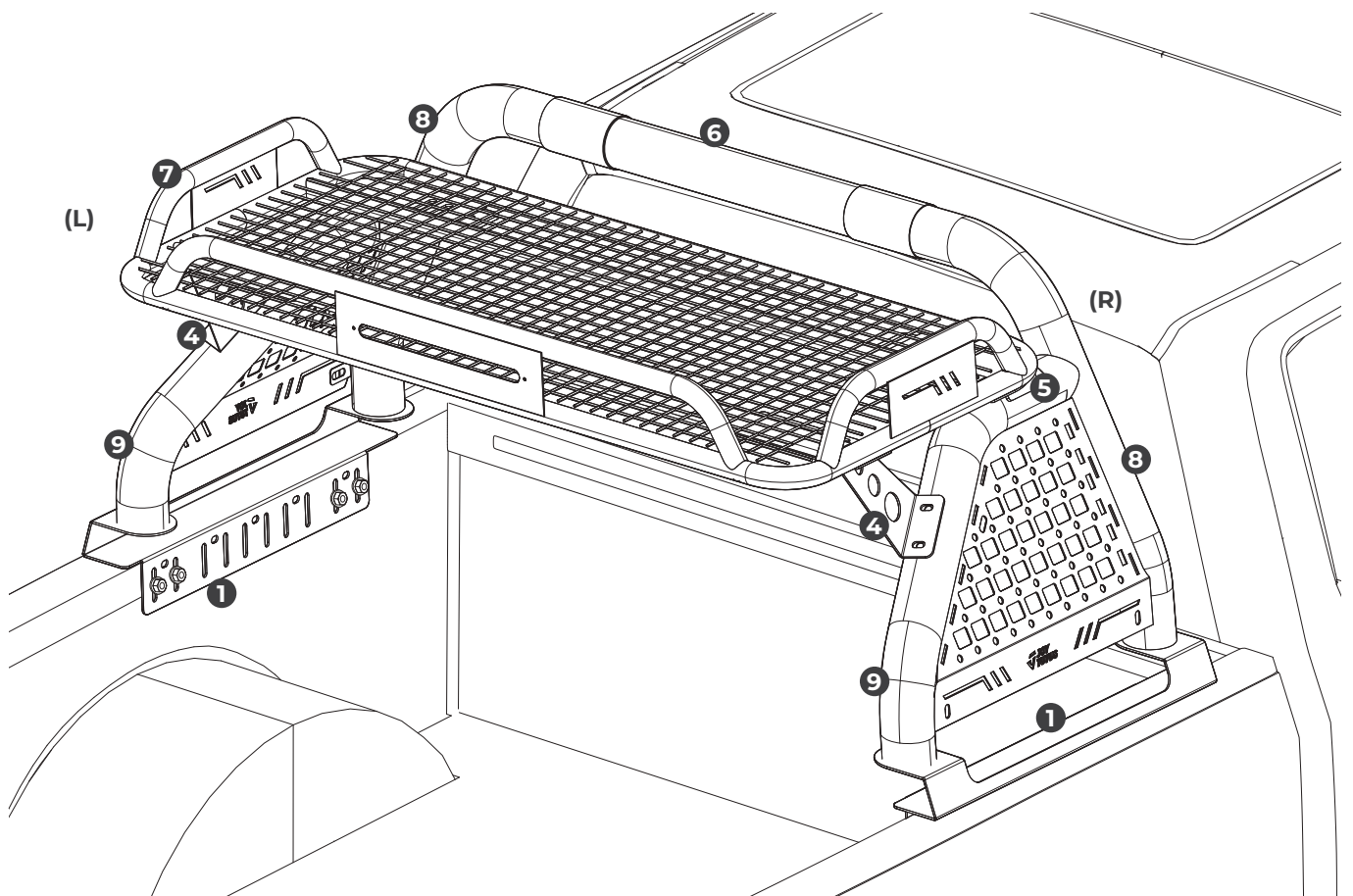
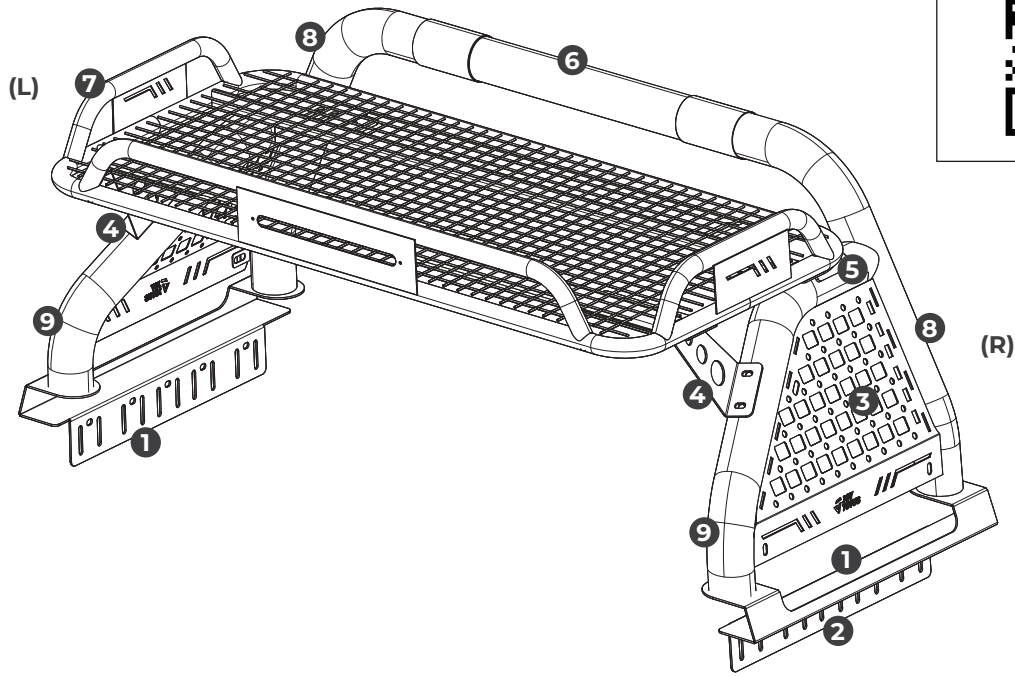

INSTALLATION TIPS

Required accessories:

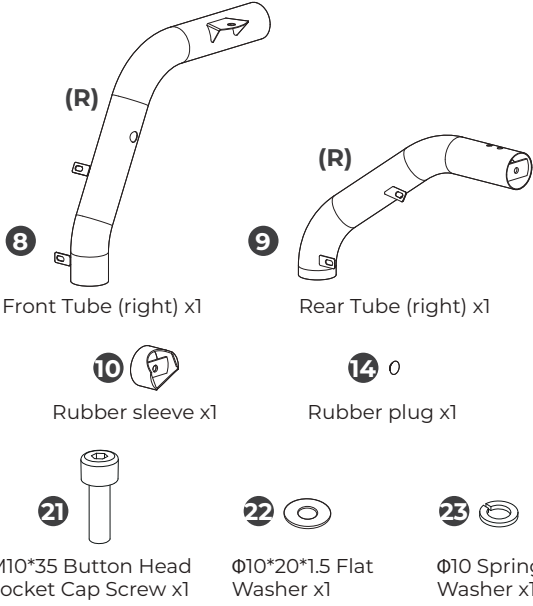

STEP 1

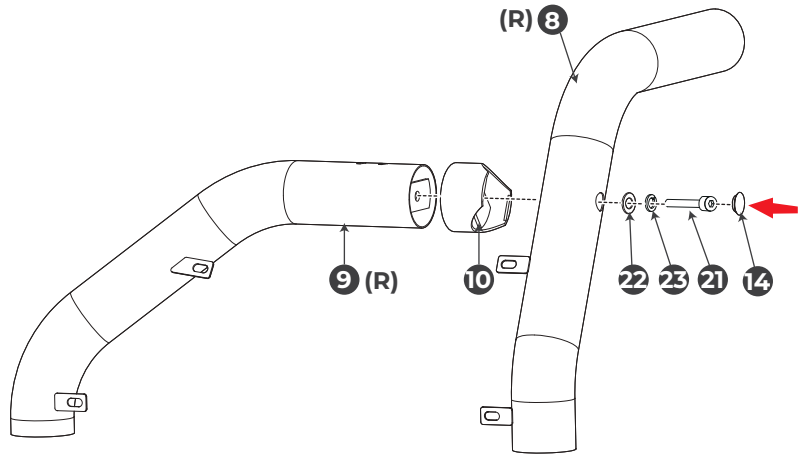

Required accessories:

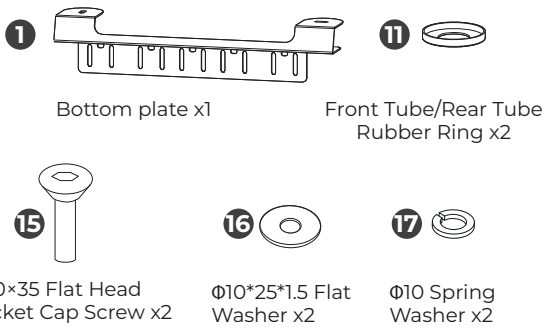

STEP 2

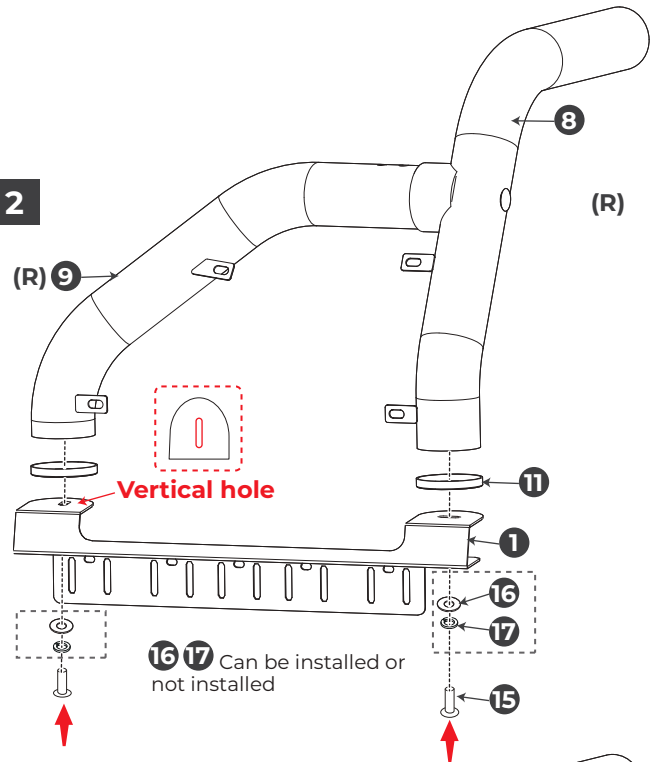

Required accessories:

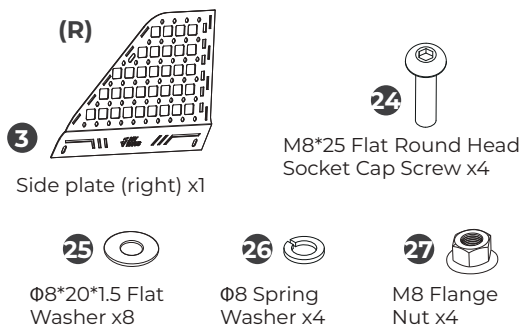

STEP 3

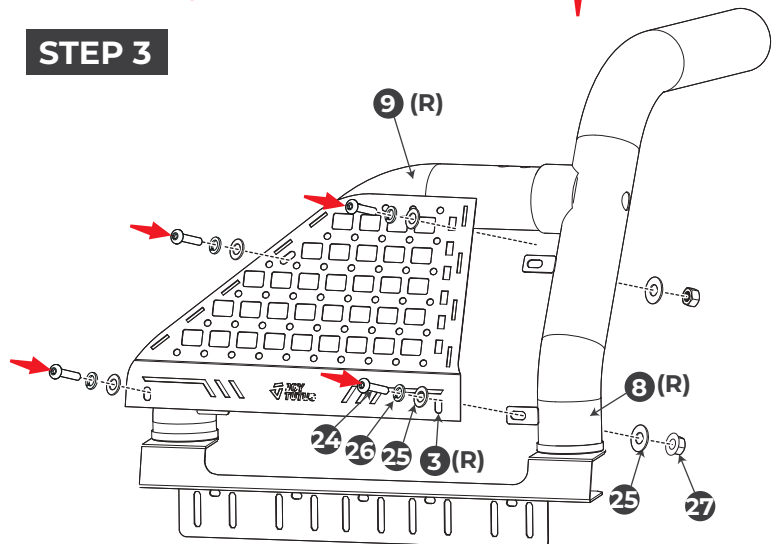

Install the left bracket using the same method

STEP 4

Required accessories:

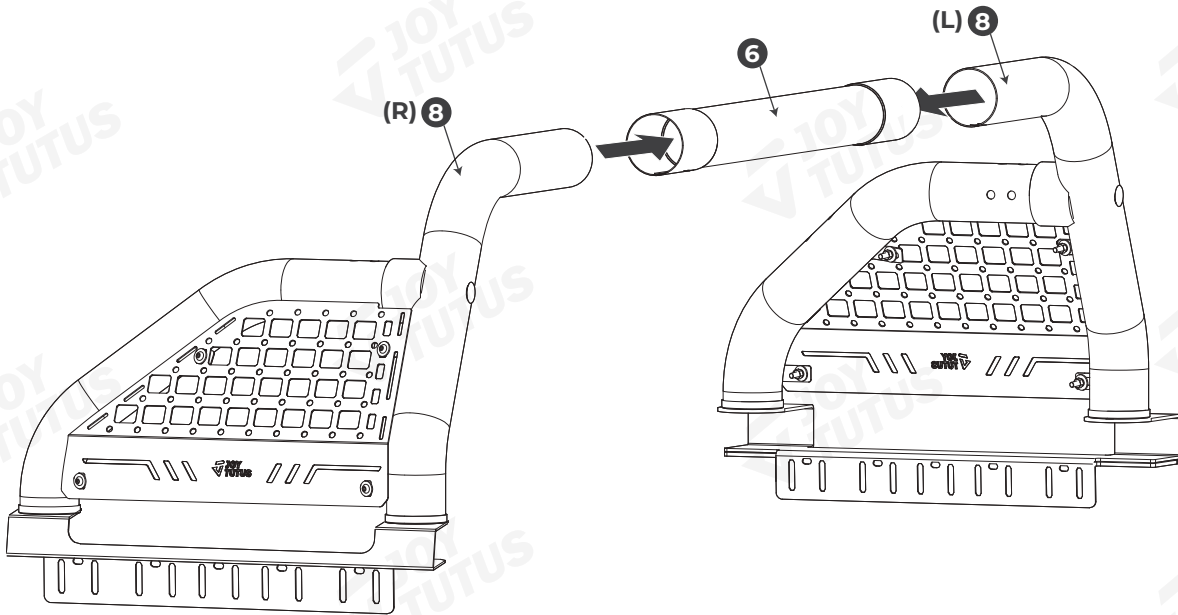
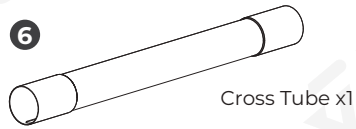

STEP 5

Required accessories:

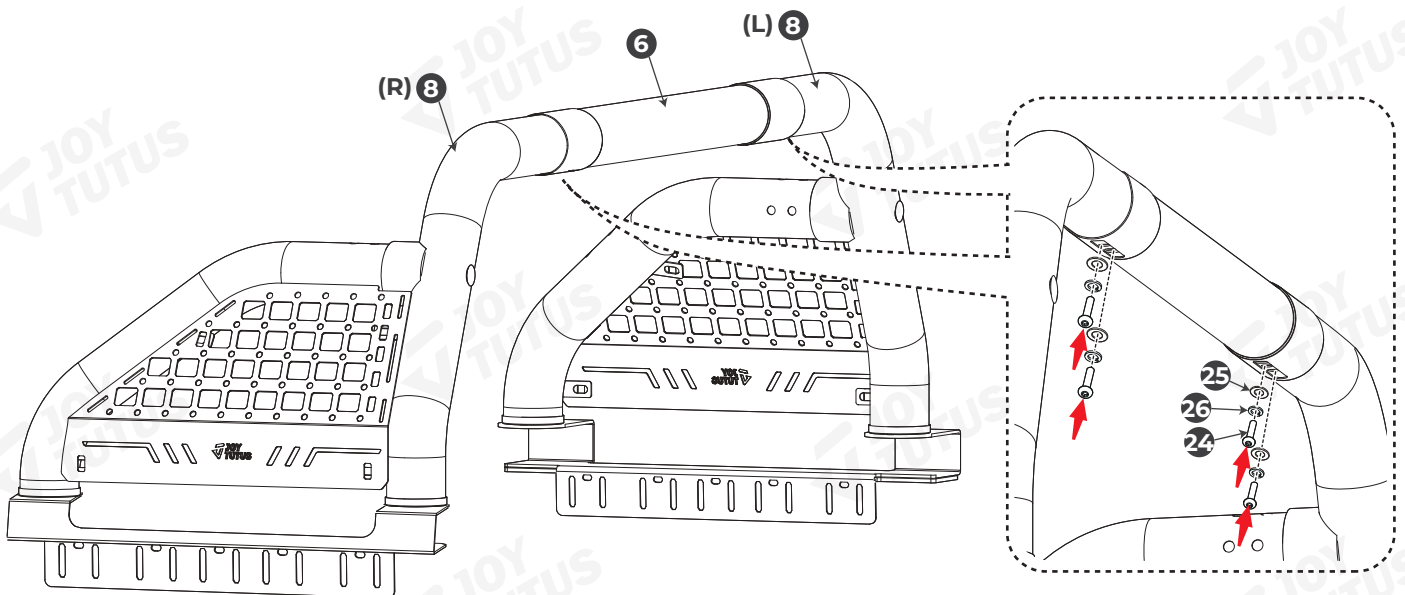
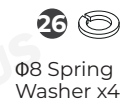

STEP 6

Required accessories:

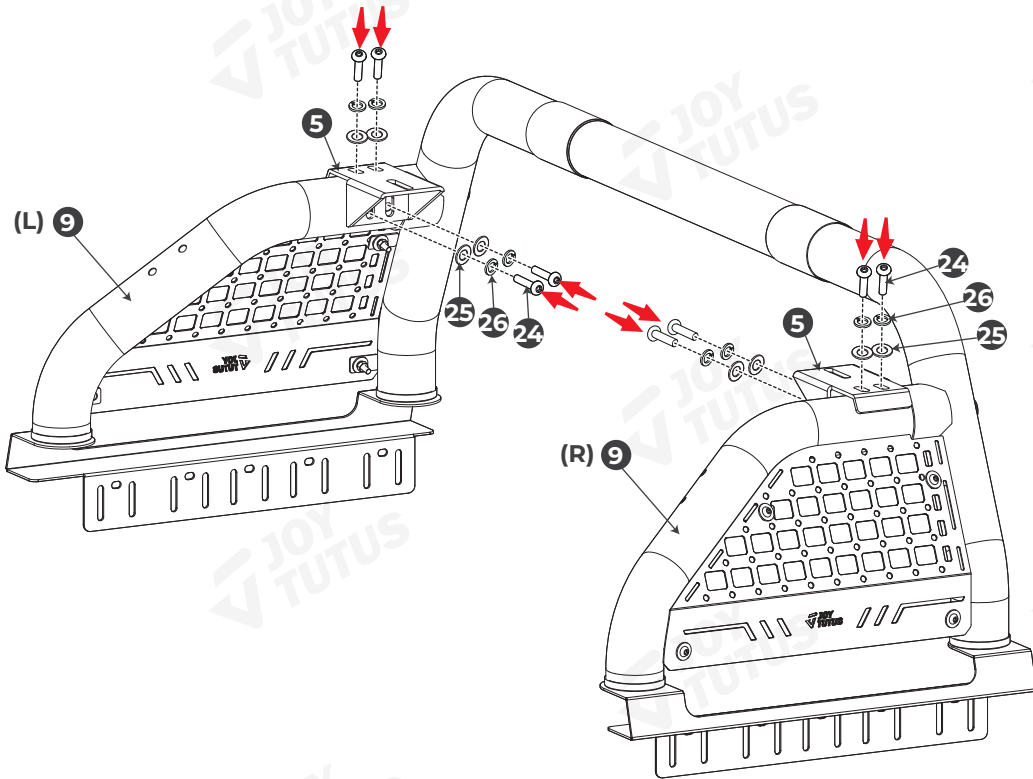
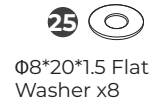

STEP 7

Required accessories:

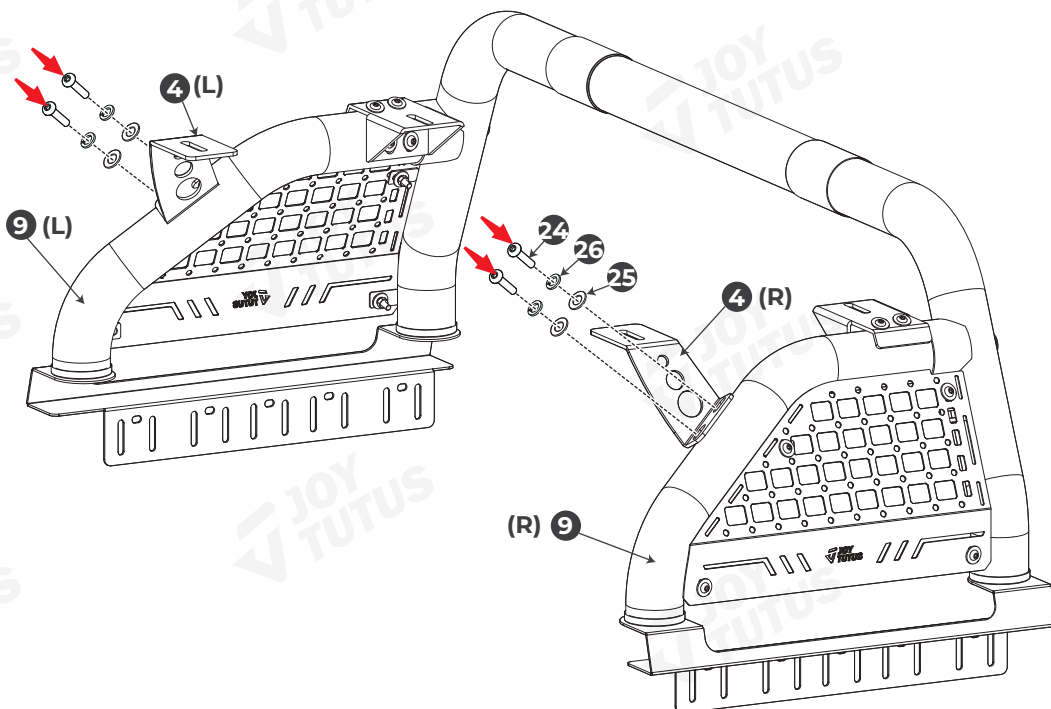
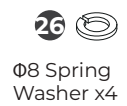
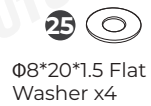
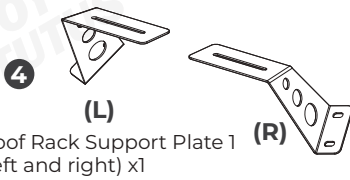

STEP 8

Required accessories:

7

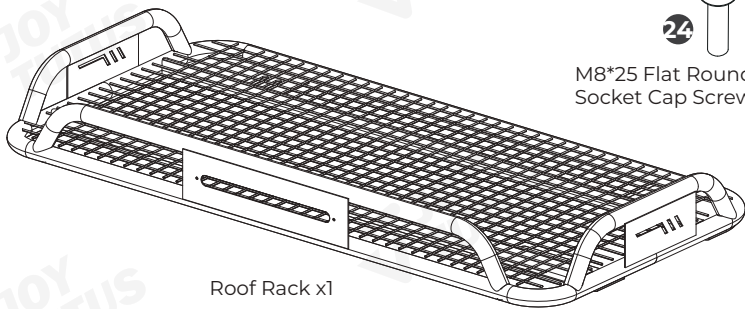

M8*25 Flat Round Head Socket Cap Screw x4



Ø8*20*1.5 Flat Washer x8



Ø8 Spring Washer x4



M8 Flange Nut x4

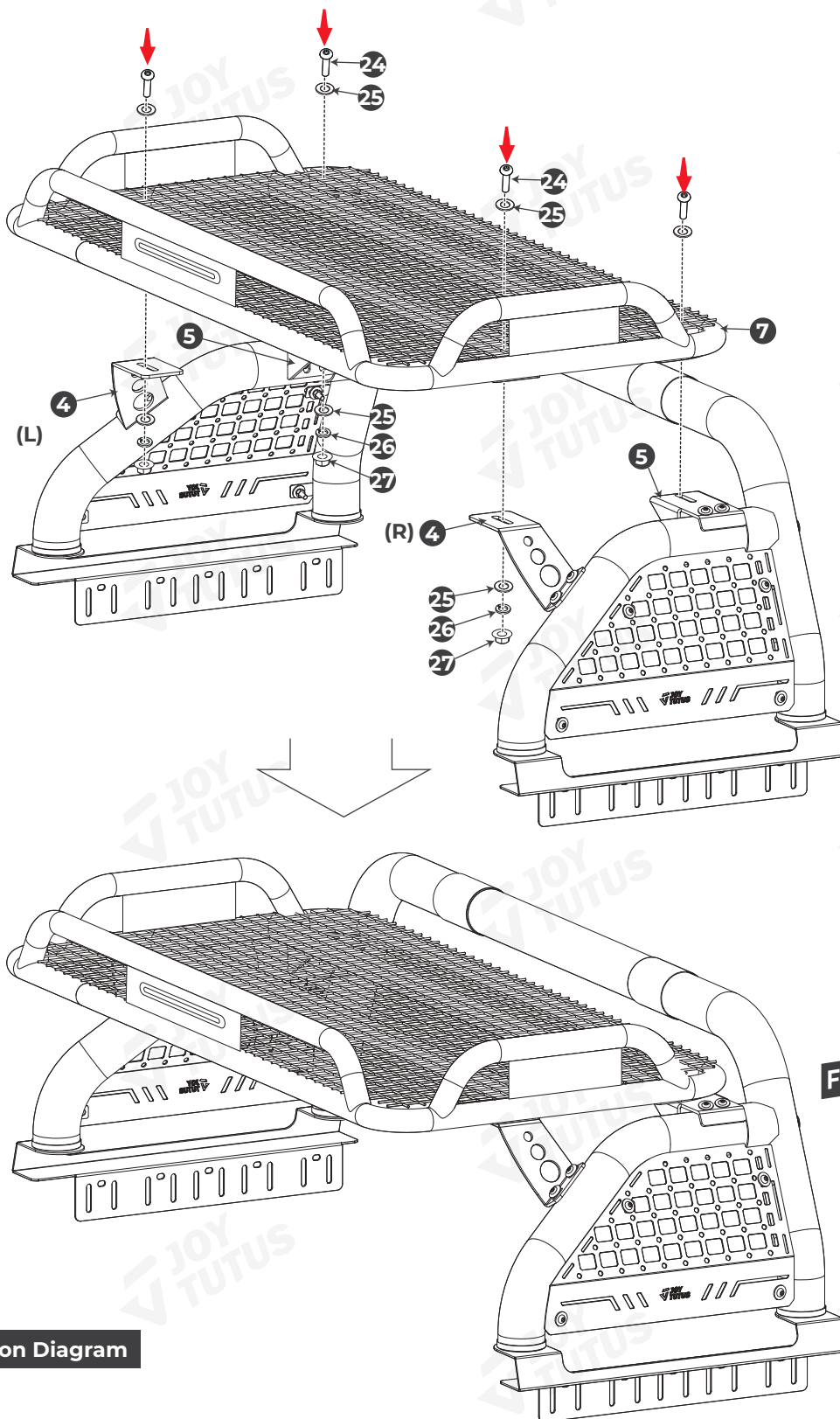

Assembly Completion Diagram

INSTALLATION (If the vehicle has a sliding rail)

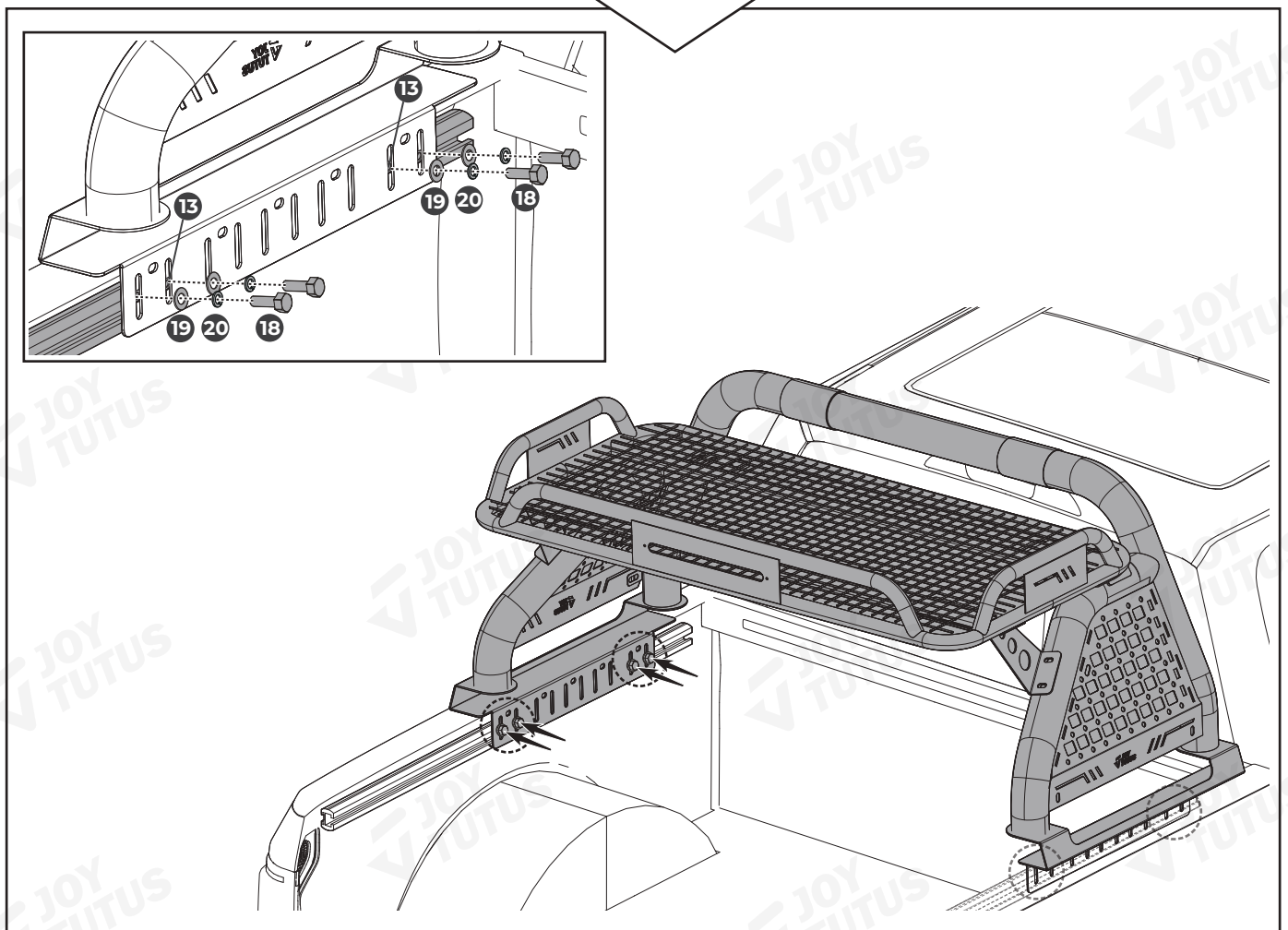
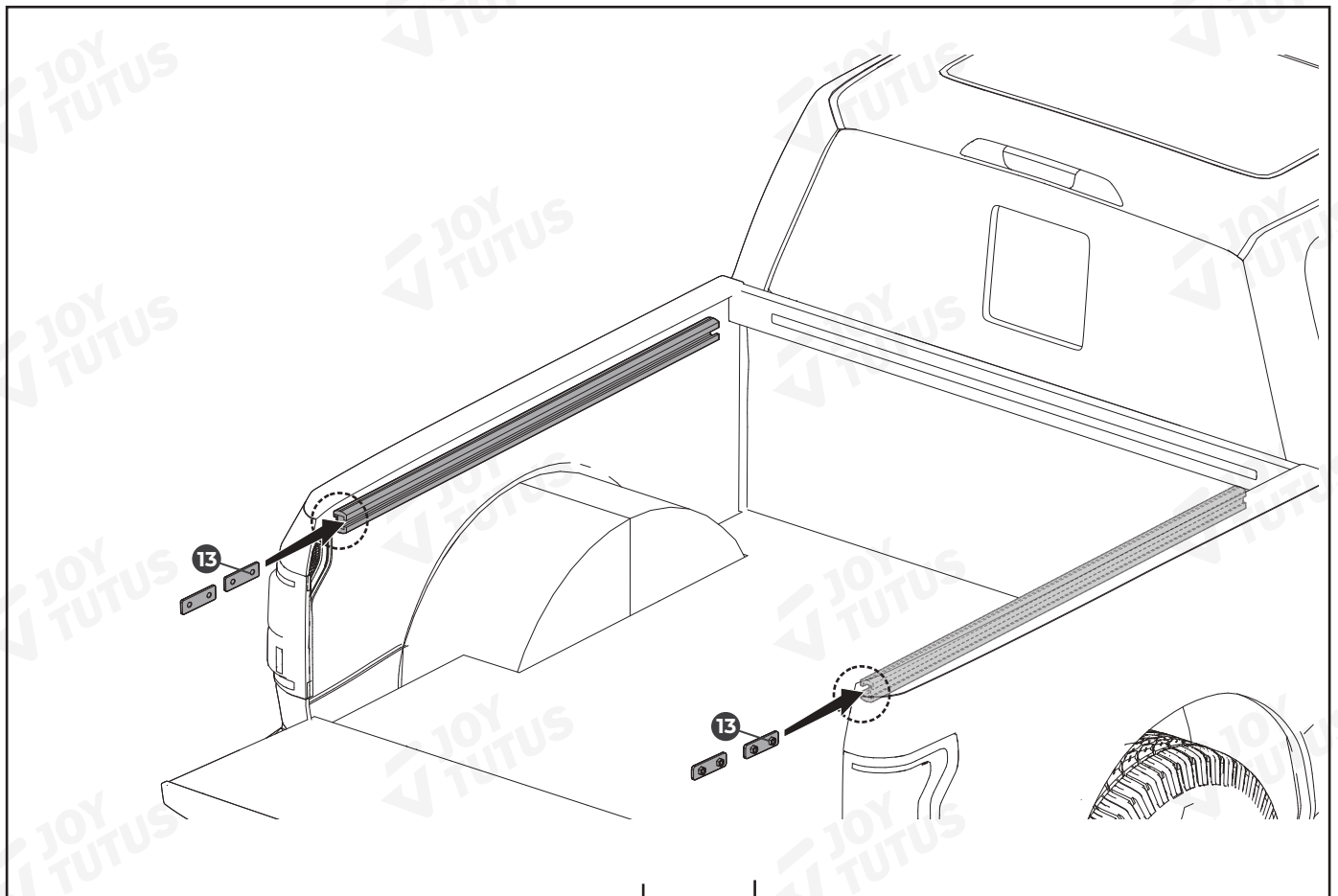

INSTALLATION (If the vehicle does not have a sliding rail)

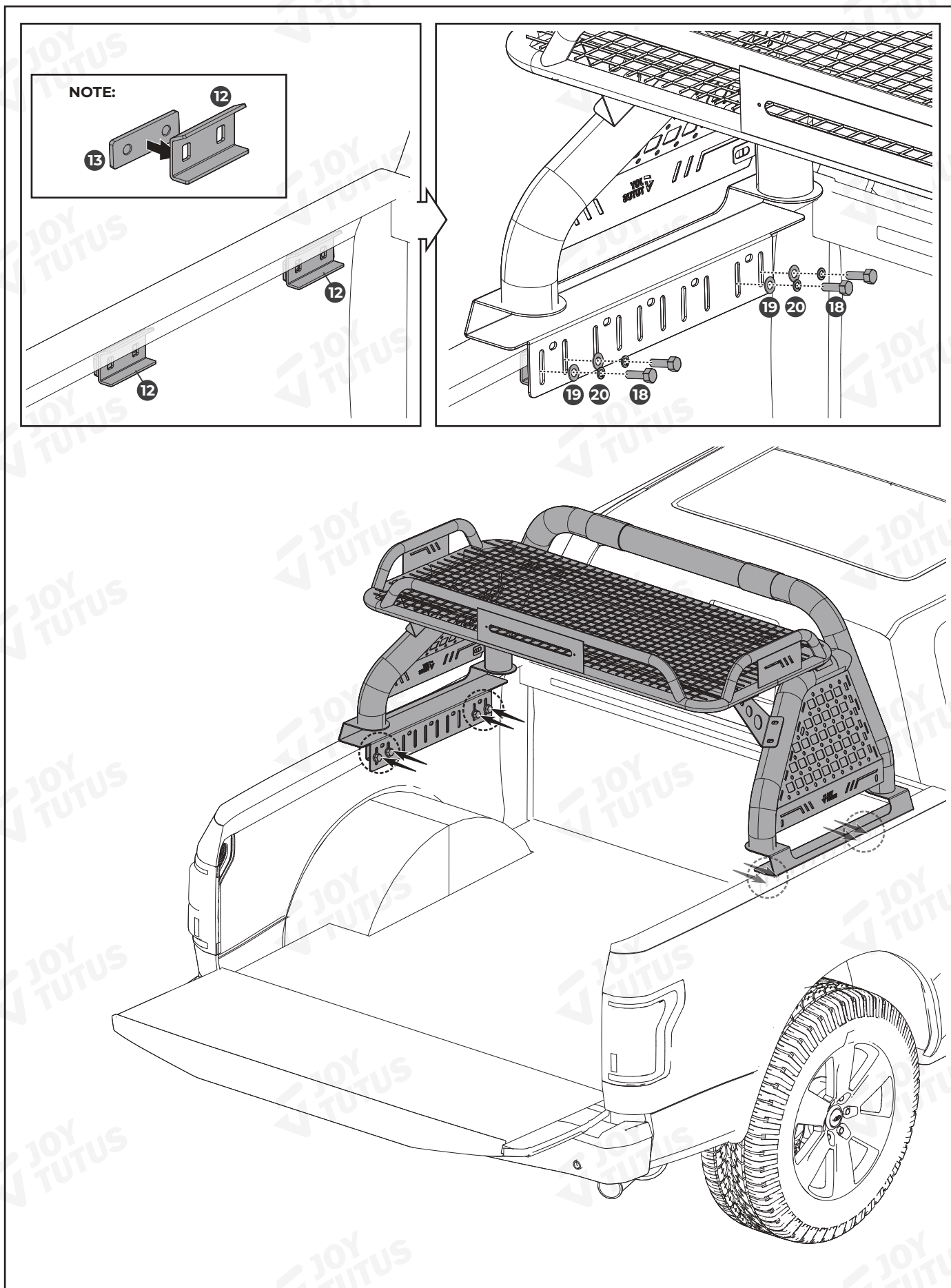

Selecting the Wire to Connect to the Tail Light or High-Mounted Brake Light



If the purchased product specification does not include a high-mounted stop lamp, please disregard this step.

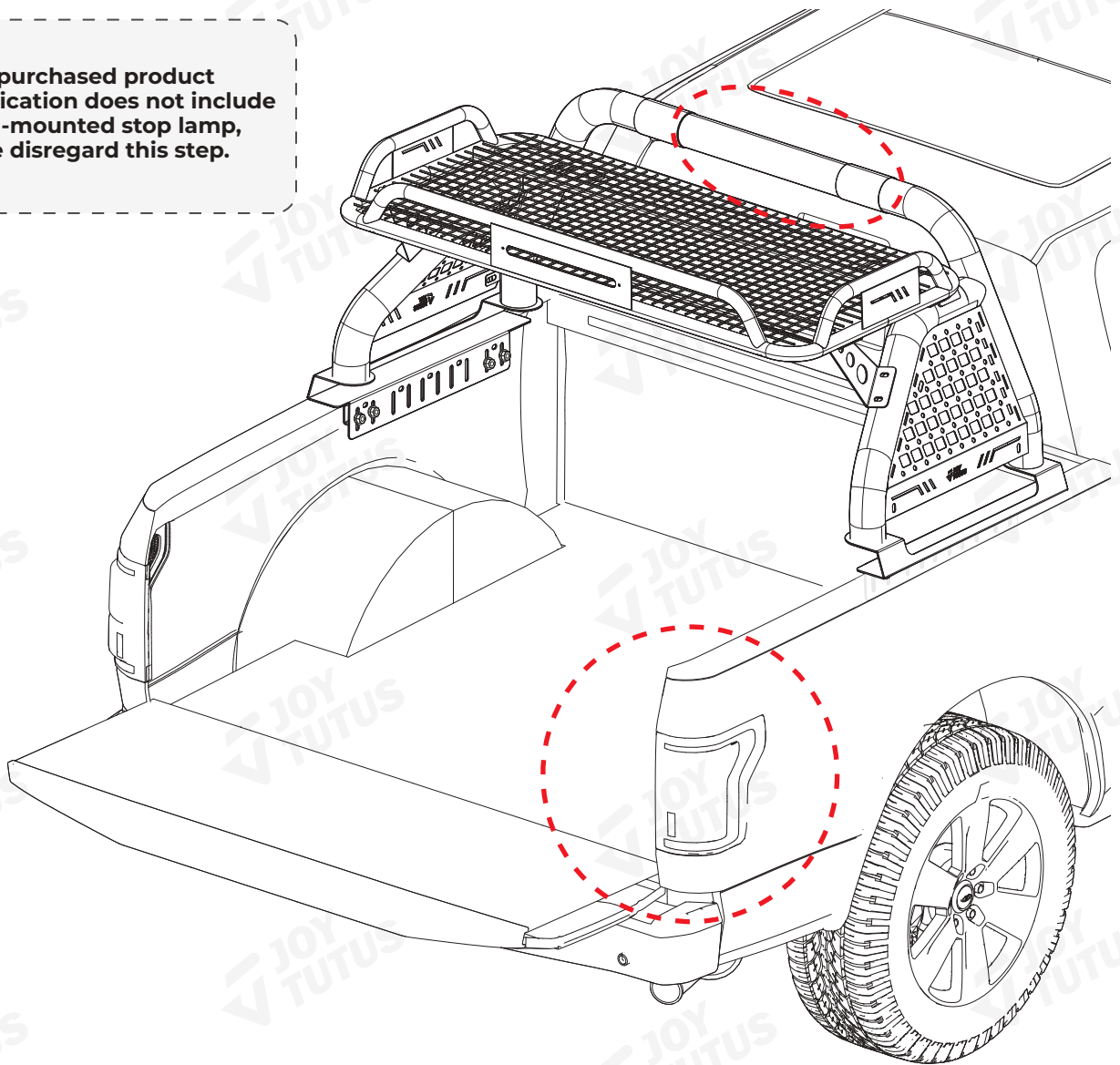

Wiring Instructions

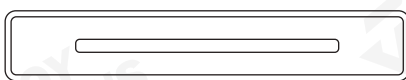

(Length: 2m)

12V 3.5A

1. Disconnect the vehicle's power supply to avoid short circuits or other issues during the wiring process.
2. Locate the tail light harness, which is typically found behind the interior panel at the rear of the vehicle. You can expose the harness by removing the trim panel near the tail lights.
3. Use a test light or multimeter to identify the brake light power wire within the tail light harness. Typically, you can determine the brake light wire by observing voltage changes when the brake pedal is pressed.
4. Once the brake light wire is identified, use a wire stripper to carefully remove the insulation, exposing the metal conductor inside.
5. Use wire terminals to connect the positive wire of the high-mounted brake light to the positive brake light power wire. Connect the negative wire of the high-mounted brake light to a grounding point on the vehicle body, ensuring the connections are secure.
6. Wrap the connection points with electrical tape to prevent leaks and short circuits.