

**IMPORTANT**

Before installation, please make sure that all accessories are ready. (As shown in the picture below).

**PRODUCT INFORMATION**

- 1 Front panel x1
- 2 Intermediate board x1
- 3 Rear panel x1
- 4 M6\*12 hexagon socket washer screw x7
- 5 M6\*55 hexagon socket washer screw x2
- 6 M6 with cushion anti loosening nut x9
- 7 M6\*30\*2 metal gasket x4
- 8 M5\*12 plum blossom self tapping screw x2
- 9 EVA foam x2
- 10 4mm ball head hex wrench x1
- 11 T25 plum blossom wrench x1
- 12 10mm socket wrench x1

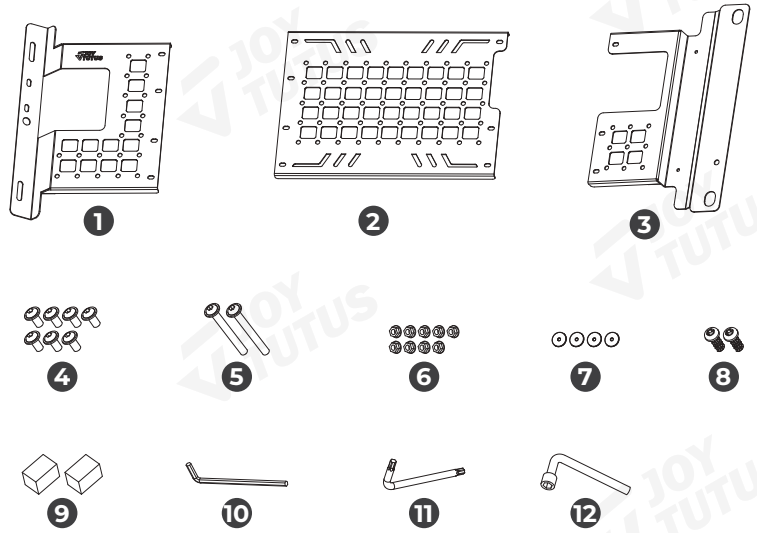

**NOTE: Suggest 2 people to install, about 15 minutes.**

**PREPARATION IN ADVANCE**

**Step 1:** Remove the original front roof.

**NOTE:** The front position is the next installation position.

If you have any questions, please visit Joytutus website or email for quick response.  
Web: [www.joytutus.com](http://www.joytutus.com)  
Email: [Service@joytutus.com](mailto:Service@joytutus.com)

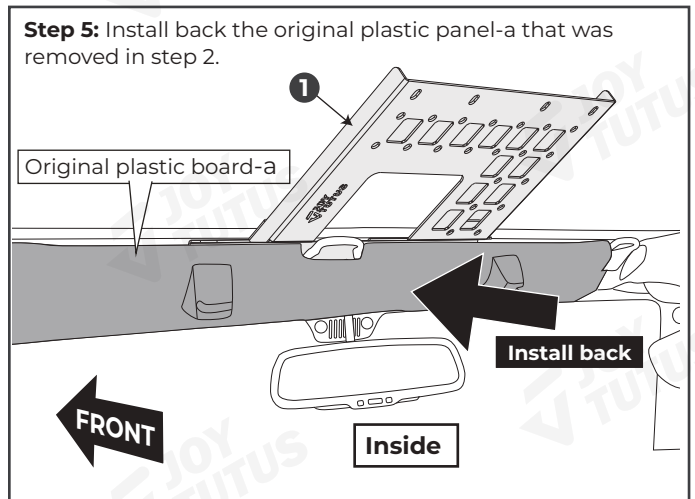
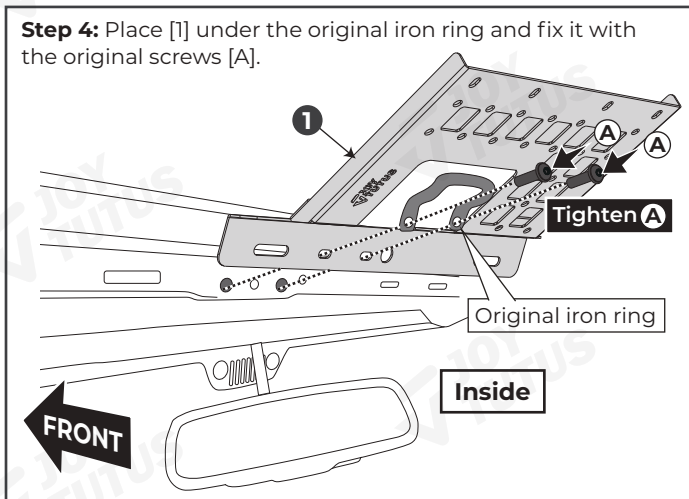
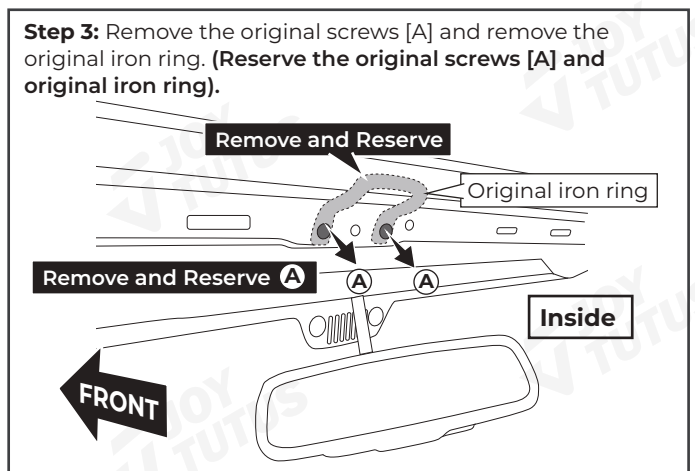
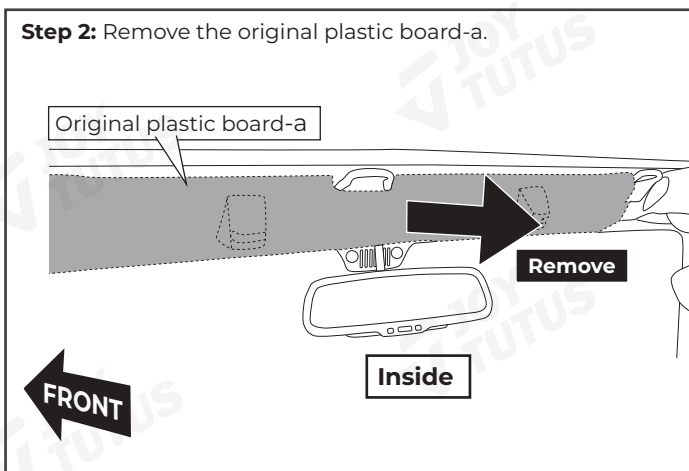

## ✓ INSTALLATION STEP

**NOTE:** According to your needs, we have two fixing methods here, mainly the installation method of accessory [3] is different.

### METHOD 1: NO ROOF NEEDED

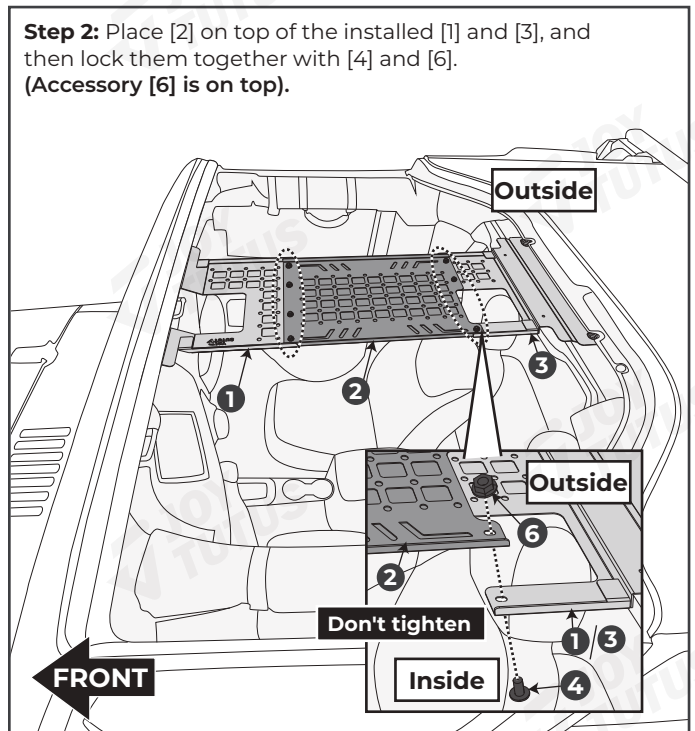
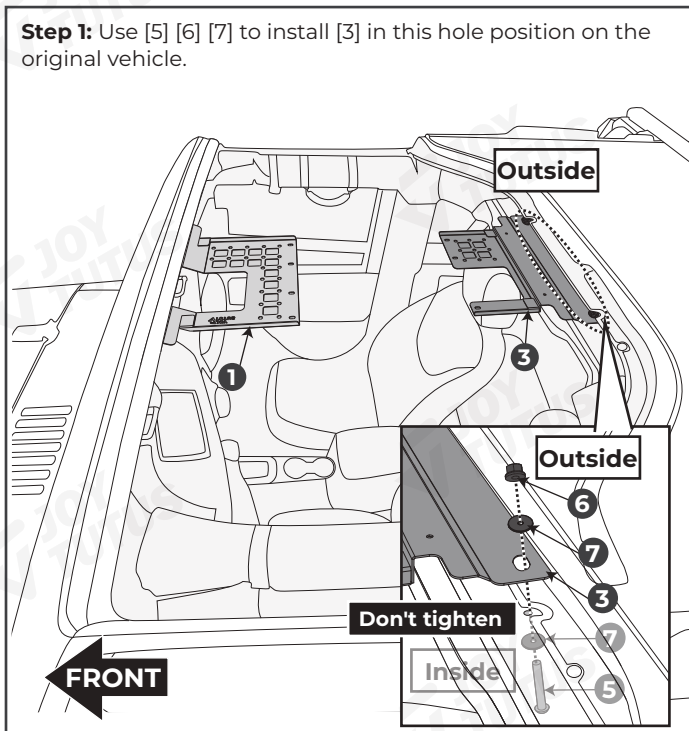

If you have any questions, please visit Joytutus website or email for quick response.  
 Web: [www.joytutus.com](http://www.joytutus.com)  
 Email: [Service@joytutus.com](mailto:Service@joytutus.com)

**Step 3:** Adjust the position of the installed [1] [2] [3] so that [3] is tightly attached to the original board case-b at the back.

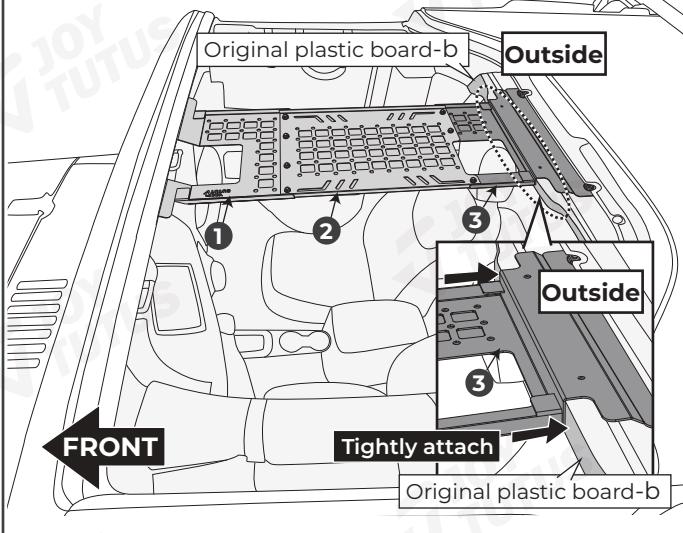

**Step 4:** Tighten all screws and nuts in steps 1 and 2.  
**Step 5:** Installation is complete.

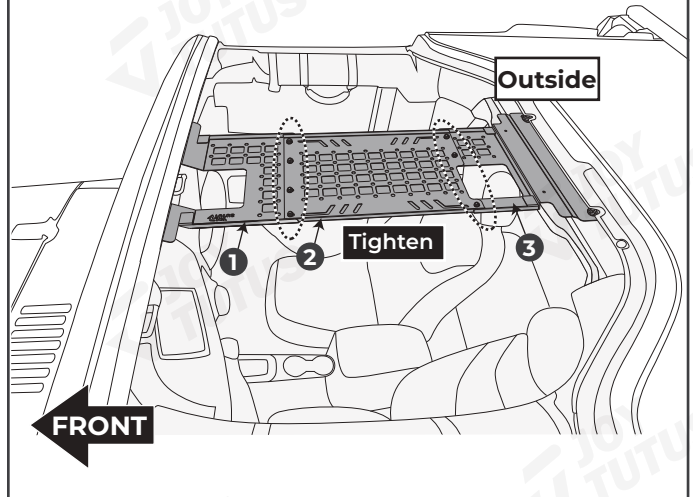

## METHOD 2: ROOF NEEDED

**Step 1:** Align [3] with holes [a] and place down, then place down [2], and connect and fix [1] [2] [3] using [4] and [6]. (Accessory [6] is on top).

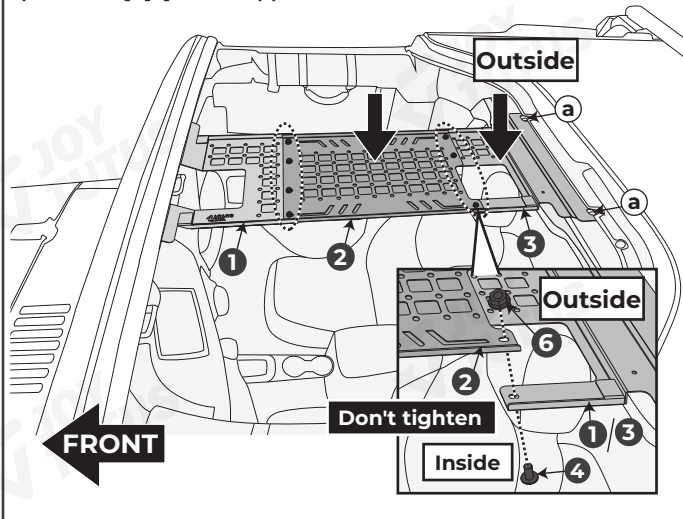

**Step 2:** Adjust the position of the installed [1] [2] [3] so that [3] is tightly attached to the original board case-b at the back.

**Step 3:** Tighten all screws and nuts in steps 1.

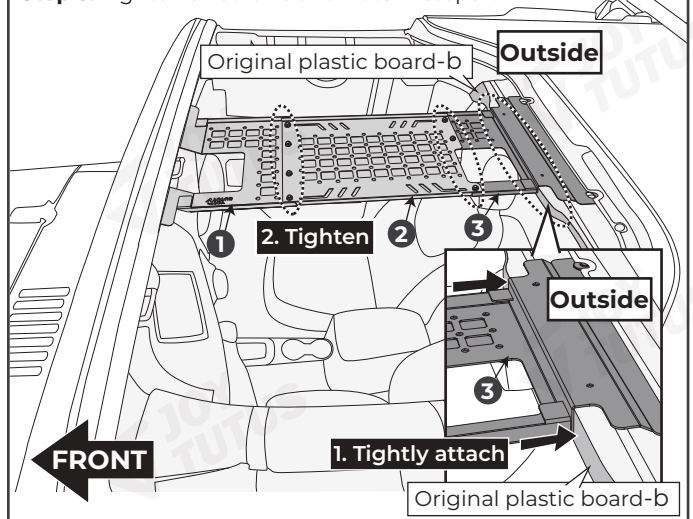

**Step 4:** Tear the adhesive backing of [9] and stick it to the approximate position on top of [3].

**NOTE:** You can install [8] at the holes [b] in [3] according to your own needs.

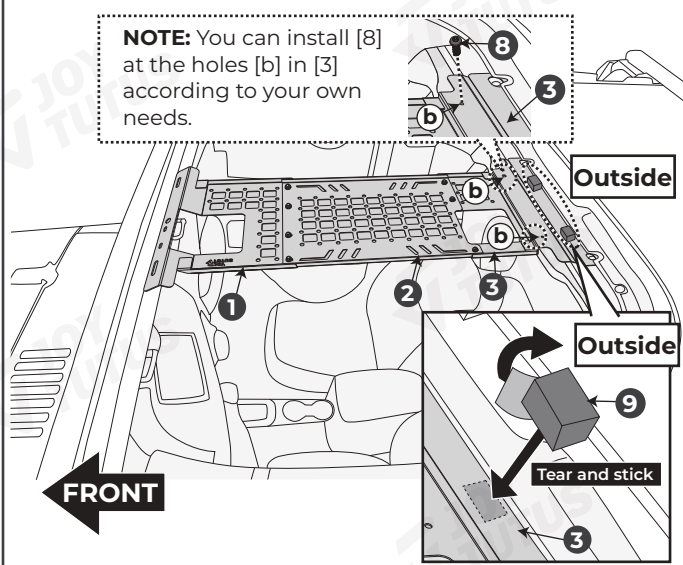

**Step 5:** Assemble the original front roof back and complete the installation.

**NOTE:** If your handle is difficult to turn, you can adjust it by loosening screw [B] appropriately.

